

CORAL LAKES SATELLITE TENNIS COURTS, A P.U.D.

114

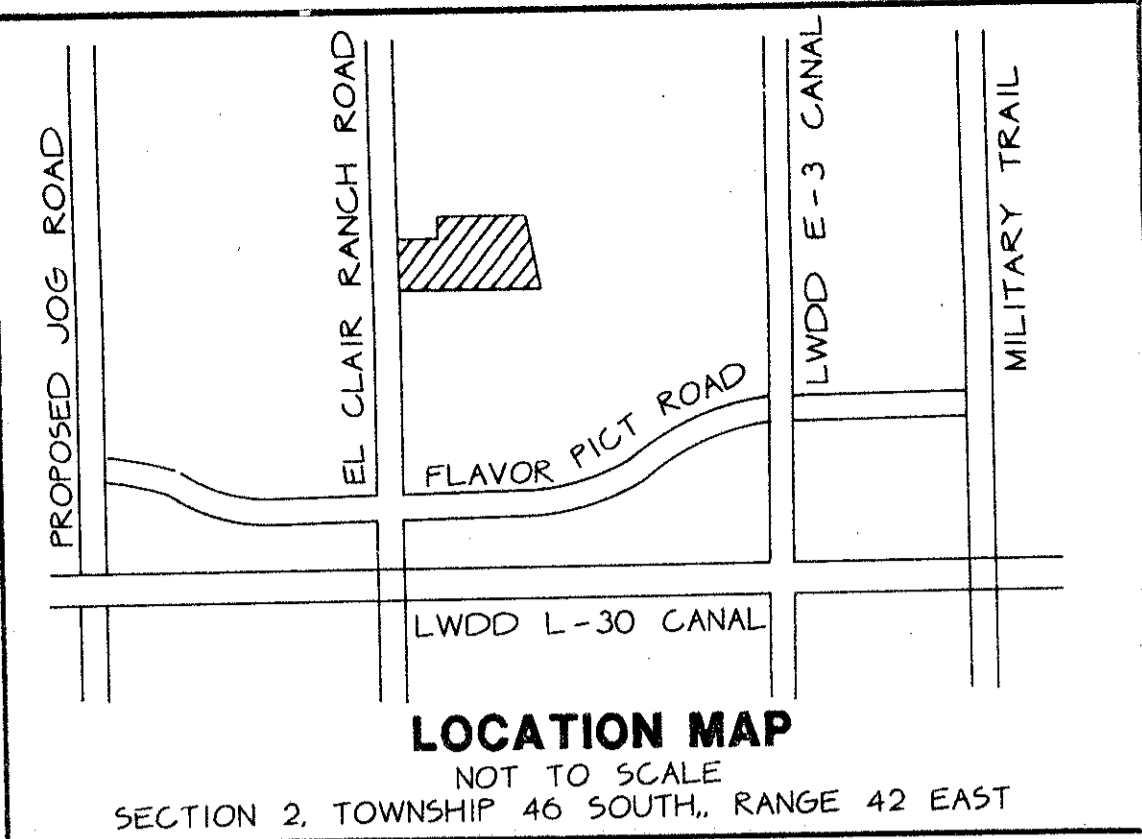

A REPLAT OF A PORTION OF TRACT B OF THE PLAT OF CORAL LAKES,
 AS RECORDED IN PLAT BOOK 67, PAGES 197 THROUGH 198 INCLUSIVE OF THE PUBLIC RECORDS OF PALM BEACH COUNTY FLORIDA
 ALL IN SECTION 2, TOWNSHIP 46 SOUTH, RANGE 42 EAST, PALM BEACH COUNTY, FLORIDA

THIS INSTRUMENT PREPARED BY JAMES E. PARK, P.L.S.
 WILLIAMS, HATFIELD & STONER, INC. - ENGINEERS PLANNERS SURVEYORS
 1901 SOUTH CONGRESS AVENUE, SUITE 150, BOYNTON BEACH, FLORIDA 33426

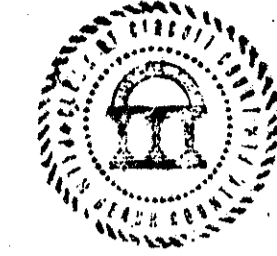

COUNTY OF PALM BEACH) ss
 STATE OF FLORIDA)
 This Plat was filed for record at 2:28 P.M.
 this 25th day of September 1994
 and duly recorded in Plat Book No. 93
 on page 114-115
 DOROTHY H. WILKEN, Clerk of Circuit Court
 by *[Signature]*

SHEET 1 OF 2

DEDICATION

KNOW ALL MEN BY THESE PRESENTS THAT ORIOLE HOMES CORP., A CORPORATION IN THE STATE OF FLORIDA, OWNER OF THE LAND SHOWN HEREON AS CORAL LAKES SATELLITE TENNIS COURTS, A P.U.D., SITUATE IN SECTION 2, TOWNSHIP 46 SOUTH, RANGE 42 EAST, A REPLAT OF A PORTION OF TRACT B OF THE PLAT OF CORAL LAKES, AS RECORDED IN PLAT BOOK 67 AT PAGES 197 THROUGH 198 OF THE PUBLIC RECORDS OF PALM BEACH COUNTY, BEING MORE PARTICULARLY DESCRIBED AS FOLLOWS:

COMMENCE AT THE NORTHWEST CORNER OF SAID TRACT B;
 THENCE ON AN ASSUMED BEARING OF S00°36'16"E ALONG THE WEST LINE OF SAID TRACT B A DISTANCE OF 767.62 FEET TO THE POINT OF BEGINNING;
 THENCE N9°00'00"E A DISTANCE OF 227.36 FEET;
 THENCE N00°00'00"E A DISTANCE OF 77.50 FEET;
 THENCE N9°00'00"E A DISTANCE OF 502.07 FEET;
 THENCE S1°07'20"E A DISTANCE OF 310.76 FEET;
 THENCE S°37'00"0"W A DISTANCE OF 806.15 FEET TO A POINT ON THE WEST LINE OF SAID TRACT B;
 THENCE N00°36'16"W ALONG SAID WEST LINE A DISTANCE OF 2225.1 FEET TO THE POINT OF BEGINNING.

SAID LAND SITUATE IN PALM BEACH COUNTY, FLORIDA CONTAINING 4.90 ACRES, MORE OR LESS.

HAVE CAUSED THE SAME TO BE SURVEYED AND PLATTED AS SHOWN HEREON AND DO HEREBY MAKE THE FOLLOWING DEDICATIONS AND RESERVATIONS:

- TRACT A, AS SHOWN HEREON, IS HEREBY RESERVED FOR THE CORAL LAKES ASSOCIATION, INC., ITS SUCCESSORS AND ASSIGNS, FOR PRIVATE ACCESS PURPOSES, DRAINAGE AND UTILITY PURPOSES, AND IS THE PERPETUAL MAINTENANCE OBLIGATION OF SAID ASSOCIATION, ITS SUCCESSORS AND ASSIGNS, WITHOUT RECOURSE TO PALM BEACH COUNTY.
- TRACT B SHOWN HEREON IS HEREBY RESERVED UNTO CORAL LAKES ASSOCIATION, INC., ITS SUCCESSORS AND ASSIGNS, TO BE ESTABLISHED FOR RECREATION AND OTHER PROPER PURPOSES AND SHALL BE THE MAINTENANCE RESPONSIBILITY OF ORIOLE HOMES CORP., ITS SUCCESSORS AND ASSIGNS, UNTIL SUCH TIME AS SAID TRACT BECOMES THE MAINTENANCE RESPONSIBILITY OF AN APPROPRIATE CONDOMINIUM AND/OR HOMEOWNERS ASSOCIATION, ITS SUCCESSORS AND ASSIGNS, WITHOUT RECOURSE TO PALM BEACH COUNTY.
- THE UTILITY EASEMENTS AS SHOWN HEREON ARE HEREBY DEDICATED IN PERPETUITY FOR THE CONSTRUCTION AND MAINTENANCE OF UTILITY FACILITIES, INCLUDING CABLE TELEVISION SYSTEMS. THE INSTALLATION OF CABLE TELEVISION SYSTEMS SHALL NOT INTERFERE WITH THE CONSTRUCTION AND MAINTENANCE OF OTHER UTILITIES.
- THE DRAINAGE EASEMENTS AS SHOWN HEREON ARE HEREBY DEDICATED IN PERPETUITY FOR DRAINAGE PURPOSES. THE MAINTENANCE OF ALL DRAINAGE FACILITIES LOCATED THEREIN SHALL BE THE PERPETUAL MAINTENANCE OBLIGATION OF THE CORAL LAKES ASSOCIATION, INC., ITS SUCCESSORS AND ASSIGNS, WITHOUT RECOURSE TO PALM BEACH COUNTY.
 PALM BEACH COUNTY SHALL HAVE THE RIGHT, BUT NOT THE OBLIGATION, TO MAINTAIN ANY PORTION OF THE DRAINAGE SYSTEM ENCOMPASSED BY THIS PLAT WHICH IS ASSOCIATED WITH THE DRAINAGE OF PUBLIC STREETS, INCLUDING THE RIGHT TO UTILIZE FOR PROPER PURPOSES ANY AND ALL DRAINAGE, LAKE MAINTENANCE AND LAKE MAINTENANCE ACCESS EASEMENTS ASSOCIATED WITH SAID DRAINAGE SYSTEM.
- THE LIMITED ACCESS EASEMENTS AS SHOWN HEREON ARE DEDICATED TO THE BOARD OF COUNTY COMMISSIONERS OF PALM BEACH COUNTY, FLORIDA, FOR THE PURPOSES OF CONTROL AND JURISDICTION OVER ACCESS RIGHTS.

IN WITNESS WHEREOF, ORIOLE HOMES CORP., A FLORIDA CORPORATION HAS CAUSED THESE PRESENTS TO BE SIGNED BY ITS PRESIDENT AND ATTESTED TO BY ITS SENIOR VICE PRESIDENT AND ITS CORPORATE SEAL TO BE AFFIXED HERETO BY AND WITH THE AUTHORITY OF ITS BOARD OF DIRECTORS.

THIS 25TH DAY OF JULY, 1994.
 ATTEST: *[Signature]* BY *[Signature]*
 ANTONIO NUNEZ SENIOR VICE PRESIDENT MARK LEVY PRESIDENT

ACKNOWLEDGEMENT

STATE OF FLORIDA
 COUNTY OF PALM BEACH
 BEFORE ME PERSONALLY APPEARED MARK LEVY AND ANTONIO NUNEZ WHO ARE PERSONALLY KNOWN TO ME OR HAVE PRODUCED AND IDENTIFICATION AND DID/DID NOT TAKE AN OATH, AND WHO EXECUTED THE FOREGOING INSTRUMENT AS VICE PRESIDENT AND SENIOR VICE PRESIDENT OF ORIOLE HOMES CORP. AND SEVERALLY ACKNOWLEDGED TO AND BEFORE ME THAT THEY EXECUTED SUCH INSTRUMENT AS SUCH OFFICERS OF SAID CORPORATION, AND THAT THE SEAL AFFIXED TO THE FOREGOING INSTRUMENT IS THE CORPORATE SEAL OF SAID CORPORATION AND THAT IT WAS AFFIXED TO SAID INSTRUMENT BY DUE AND REGULAR CORPORATE AUTHORITY, AND THAT SAID INSTRUMENT IS THE FREE ACT AND DEED OF SAID CORPORATION.
 WITNESS MY HAND AND OFFICIAL SEAL THIS 25TH DAY OF JULY, 1994.
 MY COMMISSION EXPIRES 9-28-95

[Signature]
 Marie Jean Yarnatti
 NOTARY PUBLIC
 Marie Jean Yarnatti
 PRINTED NAME

ACCEPTANCE OF RESERVATIONS

STATE OF FLORIDA
 COUNTY OF PALM BEACH
 CORAL LAKES ASSOCIATION, INC. HEREBY ACCEPTS THE RESERVATIONS TO SAID ASSOCIATION AS STATED AND SHOWN HEREON, AND HEREBY ACCEPTS ITS MAINTENANCE OBLIGATION FOR SAME AS STATED AND SHOWN HEREON.
 DATED THIS 25TH DAY OF JULY, 1994.

ATTEST: *[Signature]* BY *[Signature]*
 ELLIOTT DAVIS - SECRETARY JO ANN LEVY - VICE PRESIDENT

ACKNOWLEDGEMENT

STATE OF FLORIDA
 COUNTY OF PALM BEACH
 BEFORE ME PERSONALLY APPEARED JO ANN LEVY AND ELLIOTT DAVIS WHO ARE PERSONALLY KNOWN TO ME OR HAVE PRODUCED AND IDENTIFICATION AND DID/DID NOT TAKE AN OATH, AND WHO EXECUTED THE FOREGOING INSTRUMENT AS VICE PRESIDENT AND SECRETARY OF CORAL LAKES ASSOCIATION, INC. A FLORIDA NOT-FOR-PROFIT CORPORATION, AND SEVERALLY ACKNOWLEDGED TO AND BEFORE ME THAT THEY EXECUTED SUCH INSTRUMENT AS SUCH OFFICERS OF SAID CORPORATION, AND THAT THE SEAL AFFIXED TO THE FOREGOING INSTRUMENT IS THE CORPORATE SEAL OF SAID CORPORATION AND THAT IT WAS AFFIXED TO SAID INSTRUMENT BY DUE AND REGULAR CORPORATE AUTHORITY, AND THAT SAID INSTRUMENT IS THE FREE ACT AND DEED OF SAID CORPORATION.
 WITNESS MY HAND AND OFFICIAL SEAL THIS 25TH DAY OF JULY, 1994.
 MY COMMISSION EXPIRES 2-6-96

[Signature]
 Beverly C. Zink
 NOTARY PUBLIC
 Beverly C. Zink
 PRINTED NAME

TITLE CERTIFICATION

STATE OF FLORIDA
 COUNTY OF PALM BEACH
 WE, ALPHA TITLE COMPANY, A TITLE INSURANCE COMPANY, AS DULY LICENSED IN THE STATE OF FLORIDA, DO HEREBY CERTIFY THAT WE HAVE EXAMINED THE TITLE TO THE HEREON DESCRIBED PROPERTY THAT WE FIND THE TITLE TO THE PROPERTY IS VESTED TO ORIOLE HOMES CORP., A FLORIDA CORPORATION THAT THE CURRENT TAXES HAVE BEEN PAID AND THAT THERE ARE NO MORTGAGES OF RECORD AND THAT THERE ARE NO OTHER ENCUMBRANCES OF RECORD.
 ALPHA TITLE COMPANY
 DATE August 1st 1994 BY *[Signature]*
 EDWARD F. JOYCE VICE PRESIDENT

SURVEYOR'S CERTIFICATE

THIS IS TO CERTIFY THAT THE PLAT SHOWN HEREON IS A TRUE AND CORRECT REPRESENTATION OF A SURVEY MADE UNDER MY RESPONSIBLE DIRECTION AND SUPERVISION THAT SAID SURVEY IS ACCURATE TO THE BEST OF MY KNOWLEDGE AND BELIEF. THAT PERMANENT REFERENCE MONUMENTS ("PRMS") HAVE BEEN PLACED AS REQUIRED BY LAW AND THAT PERMANENT CONTROL POINTS ("C.P.'S") WILL BE SET UNDER THE GUARANTEES POSTED WITH THE PALM BEACH COUNTY BOARD OF COUNTY COMMISSIONERS FOR THE REQUIRED IMPROVEMENTS AND, FURTHER, THAT THE SURVEY DATA COMPLIES WITH ALL THE REQUIREMENTS OF CHAPTER 177, FLORIDA STATUTES, AS AMENDED, AND THE ORDINANCES OF PALM BEACH COUNTY, FLORIDA.

[Signature]
 JAMES E. PARK
 REGISTERED SURVEYOR NO. 3915
 STATE OF FLORIDA

NOTES

- ALL BEARINGS SHOWN HEREON ARE RELATIVE TO AN ASSUMED BEARING BASED ON THE WEST LINE OF THE SOUTHWEST ONE-QUARTER OF SECTION 2, TOWNSHIP 46 SOUTH, RANGE 42 EAST BEING N00°36'16"W.
- DE - DENOTES DRAINAGE EASEMENTS
 O - DENOTES PERMANENT REFERENCE MONUMENT (P.R.M.) NO. 3915
 UE - DENOTES UTILITY EASEMENT
 LWDD - DENOTES LAKE WORTH DRAINAGE DISTRICT
 CL - DENOTES CENTERLINE
 RW - DENOTES RIGHT-OF-WAY
 OR - DENOTES OFFICIAL RECORDS
 P.O.B. - DENOTES POINT OF BEGINNING
 P.O.C. - DENOTES POINT OF COMMENCEMENT
- THERE MAY BE ADDITIONAL RESTRICTIONS THAT ARE NOT RECORDED ON THIS PLAT THAT MAY BE FOUND IN THE PUBLIC RECORDS OF THIS COUNTY.
- NO BUILDINGS OR ANY KIND OF CONSTRUCTION OR TREES OR SHRUBS SHALL BE PLACED ON ANY EASEMENT WITHOUT PRIOR WRITTEN APPROVAL OF ALL EASEMENT BENEFICIARIES AND ALL APPLICABLE COUNTY APPROVALS OR PERMITS AS REQUIRED FOR SUCH ENCROACHMENTS.
- IN INSTANCES WHERE DRAINAGE AND UTILITY EASEMENTS INTERSECT, THOSE AREAS OF INTERSECTION ARE DRAINAGE AND UTILITY EASEMENTS. CONSTRUCTION, OPERATION AND MAINTENANCE OF UTILITIES WITHIN THESE AREAS OF INTERSECTION SHALL NOT INTERFERE WITH THE CONSTRUCTION, OPERATION AND MAINTENANCE OF DRAINAGE FACILITIES.
- BUILDING SETBACK LINES SHALL BE AS REQUIRED BY CURRENT PALM BEACH COUNTY ZONING REGULATIONS AND/OR ANY RESTRICTIVE COVENANTS PERTAINING TO THAT PORTION OF THE PLANNED UNIT DEVELOPMENT REFLECTED BY THIS PLAT.

APPROVALS

BOARD OF COUNTY COMMISSIONERS OF PALM BEACH COUNTY, FLORIDA
 THIS PLAT IS HEREBY APPROVED FOR RECORD THIS 20 DAY OF SEPT 1994
 BY *[Signature]*
 WARE MCCARTY - CHAIR
 ATTEST: DOROTHY H. WILKEN, CLERK
[Signature]
 DEPUTY CLERK
 COUNTY ENGINEER:
 THIS PLAT IS HEREBY APPROVED FOR RECORD THIS 20 DAY OF SEPT 1994
 BY *[Signature]*
 GEORGE WELLS, P.E. - COUNTY ENGINEER

PET. 614-013
 ALLOC. #0001
 5/3/3/K

0614-008

CORAL LAKES SATELLITE TENNIS COURTS 73/114

SUBDIVISION * CORAL LAKES SATELLITE TENNIS COURTS
 BOOK 73 PAGE 114-115
 FLOOD ZONE B
 QUAD * 36 ZONING AR
 SE ZIP CODE 33437
 EIR NAME same
 2/16/94

TAZ-456

